

## INSPECTION

### NOTICE:

When using a vise, do not overtighten it.

#### 1. INSPECT STEERING LOCK OPERATION

Check that the steering lock mechanism operates properly.

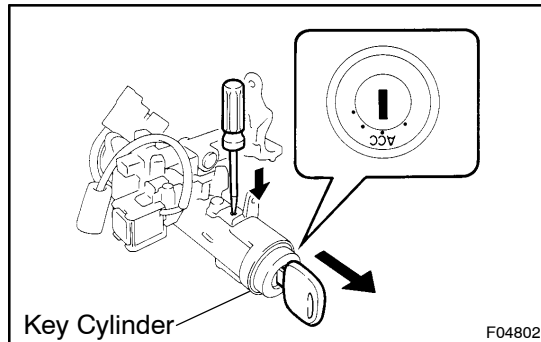

#### 2. IF NECESSARY, REPLACE KEY CYLINDER

- Place the ignition key at the ACC position.
- Using a screwdriver, push down the stop pin of the cylinder, and pull out the key cylinder.
- Install a new cylinder.

### HINT:

Make sure the key is at the ACC position.

#### 3. INSPECT IGNITION SWITCH

(See page [BE-26](#))

#### 4. IF NECESSARY, REPLACE IGNITION SWITCH

- Remove the 2 screws.
- Install a new switch with the 2 screws.

#### 5. INSPECT KEY UNLOCK WARNING SWITCH

(See page [BE-26](#))

#### 6. IF NECESSARY, REPLACE KEY UNLOCK WARNING SWITCH

- Slide out the switch.
- Slide in a new switch.

#### 7. INSPECT KEY INTERLOCK SOLENOID

(See page [AT-13](#))

#### 8. IF NECESSARY, REPLACE KEY INTERLOCK SOLENOID

- Remove the 2 screws.
- Install a new solenoid with the 2 screws.

#### 9. INSPECT TRANSPONDER KEY COIL

(See page [BE-195](#))

#### 10. IF NECESSARY, REPLACE TRANSPONDER KEY COIL

#### 11. IF NECESSARY, REPLACE TRANSPONDER KEY AMPLIFIER

- Remove the 2 screws.
- Install a new key amplifier with the 2 screws.

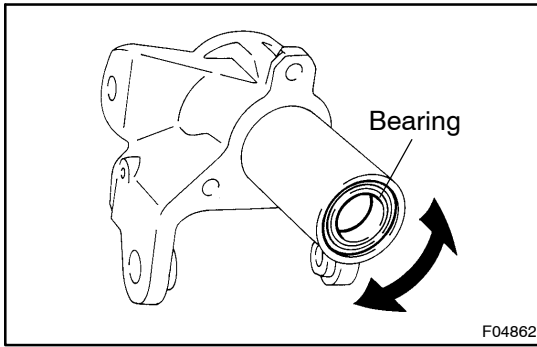

## 12. INSPECT BEARING

- (a) Check the bearing rotation condition and check for abnormal noise.  
If the bearing is worn or damaged, replace the column upper tube.
- (b) Coat the bearing with molybdenum disulfide lithium base grease.

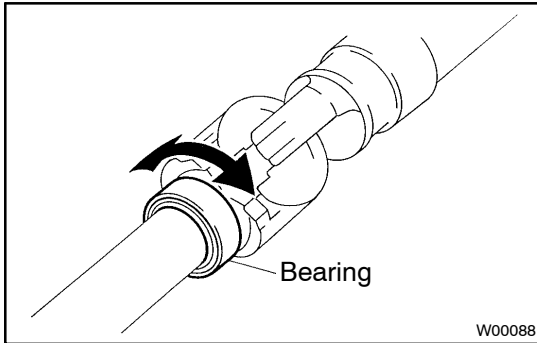

## 13. INSPECT BEARING

- (a) Check the bearing rotation condition of the main shaft assembly and check for abnormal noise.  
If necessary, replace bearing.
- (b) Coat the bearing with molybdenum disulfide lithium base grease.